



## Expression of Interest

# Self Assessment Form for Solar Power

### Basic notes before you begin

- The roof space where the solar panels are to be installed should face North, North East or North West. Panels can be tilted towards North. On roofs facing other directions eg West - there will be additional costs as this type of special tilting is more involved and needs additional materials.
- The roof space should be free from shading by trees and buildings during the summer **and** winter months. Remember, shadows cast during winter are longer than summer shadows. Consider trees that could grow over time, especially in the neighbour's yard!
- The main power-producing hours of the day are generally between 10am and 2pm – check to see if your proposed roof space will receive this “window” of sunlight.

<b>Owner's name</b>		
<b>Installation address</b>		
<b>Postal address</b>		
<b>Contact details</b>	<b>Phone</b>	<b>Mobile</b>
	<b>Fax</b>	<b>Email</b>
The building & system details		
Please select size of system you are interested in (each kW takes approx. 7.5m <sup>2</sup> of roof space), as follows: <input type="checkbox"/> 3kW <input type="checkbox"/> 5kW <input type="checkbox"/> 10kW		
Please select orientation of roof: <input type="checkbox"/> North <input type="checkbox"/> North East <input type="checkbox"/> North West <input type="checkbox"/> Other - Please explain:		
Un-shaded roof space available to mount the panels in m <sup>2</sup> :		
Approx. angle of roof (Note: most roofs are between 15 and 30 degrees):		
Type of roof material (eg corrugated iron, trim deck, terracotta tile etc)		
How many levels does the building have: <input type="checkbox"/> Single storey <input type="checkbox"/> 2 storey <input type="checkbox"/> Other - Please explain:		
How many meter-boxes does the building have (exclude hot water and off peak meters):		
Please give a brief description of the building (eg house, shearing shed, community hall etc):		
Are you a financial member of Little River Landcare Group Inc.: <input type="checkbox"/> Yes <input type="checkbox"/> No		

# Photos and sketches

Please have a look at diagram below and sketch in any useful information about the location of panels and other issues including describing the location of the meter-box and / or sub-meter.

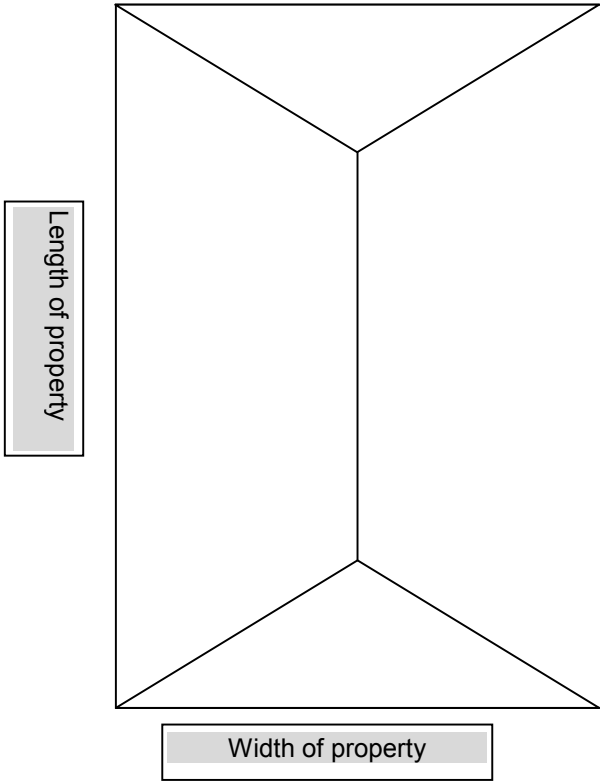

- Please show North in relation to the building.
- Please note meter-box details - if away from the building please describe distance and set up.
- Please take photos of meter-box, sub board, roof width and roof close up. See examples at bottom of the page.

### Meter-box and other info:

---

---

---

---

---

---

---

---

---

---



Sample of photos required

